

# ALGORITHMIC SOUNDER

## AE/SA-AS1

### Description

Low consumption acoustic sounder for indoor use designed to be used with AGUILERA ELECTRONICA algorithmic fire detection plants.

The sounder is personalized in the Algorithmic Central with the name of the area where it is installed.

It incorporates a module that identifies it individually with a number within the installation loop. This number is stored in EEPROM memory so it is maintained even if the sounder is without power for a long time.

It does not need auxiliary power for its operation, being fed from the algorithmic loop itself.



### Wiring diagram

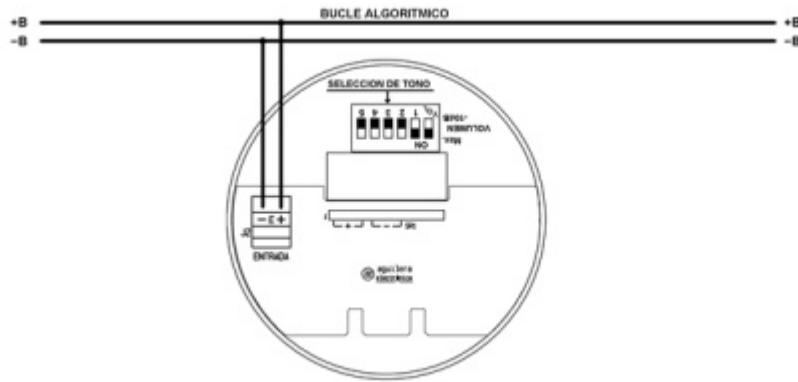

Before installing it is necessary to code the address that the siren will occupy within the algorithmic loop (see Equipment Coding).

#### Cabling.

Disconnect the supply voltage from the detection loop before module installation.

- Connect the positive input of the detection loop + B to the + E terminal.
- Connect the negative input of the detection loop -B to the - E terminal.

### Installation

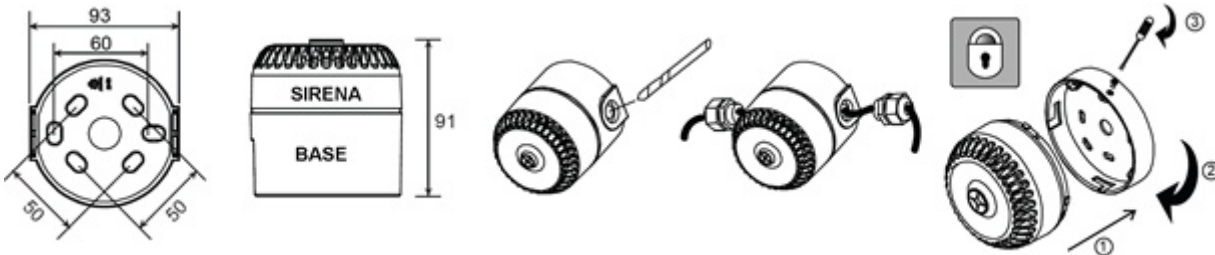

#### TECHNICAL CHARACTERISTICS

Supply voltage:	18 ~ 27 V (Bucle Algoritmico tarjeta AE/SA-CTL).
Consumption in standby:	1 mA
Consumption in alarm:	6 mA (Tone 16, 660Hz, 150ms On, 150 ms Off)
Sound intensity:	100 dB @1m (Tono 16), It depends on the selected pitch.
Temperature range:	-10° - +55° C (room temperature)
Humidity range:	Relative humidity 10% - 90% non-condensing
Housing material:	ABS V0 red
IP:	IP65
Dimensions:	93 mm Ø x 91mm.
Weight:	220g

#### CERTIFICATIONS

0099/CPD/A74/0196

